

20K Foot Operated Dump Style Control Guns

**Typical Foot Gun Hookup** These foot operated control valves (foot guns) are designed for smooth reliable operation. They are easily rebuilt in the field in 30 seconds by unscrewing the dump tube, which removes the used valve assembly. The operator then snaps a new cartridge style valve into the dump tube adapter and returns the whole assembly to the gun.

To prevent low pressure water from the flex lance nozzle spraying back towards the operator, when the foot gun is in dump mode, it is recommended that a Nozzle Shut-off Valve (Part # 61-025-001) is used between the foot gun and the flex lance. This will help to minimize cleanup at the end of the job and greatly assist the operator when inserting the lance into the next tube.

Strain Relief Whip Hoses (Part # 43-004-003) are designed to relieve the forces on the flex lance end fitting, which extends the life of the lance, and reduces the risk to the operator associated with the end fitting failing prematurely.



Part #	Description
61-020-003	Complete Foot Style Control Gun

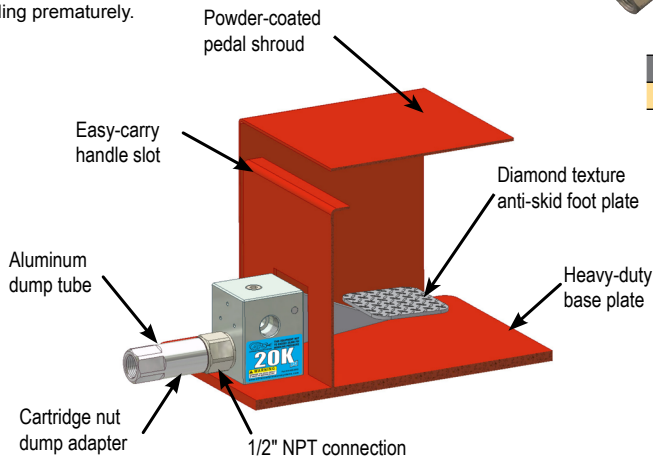

Features:

- Fully enclosed safety shrouds.
- Easy-carry handles.
- Quick-change cartridge overhaul.
- Non-slip diamond texture foot pedals.
- Powder-coated pedal shroud.
- Cartridge nut / dump adapter.
- 9/16" MP connection.
- Aluminum dump tube.
- Heavy-duty base plate.

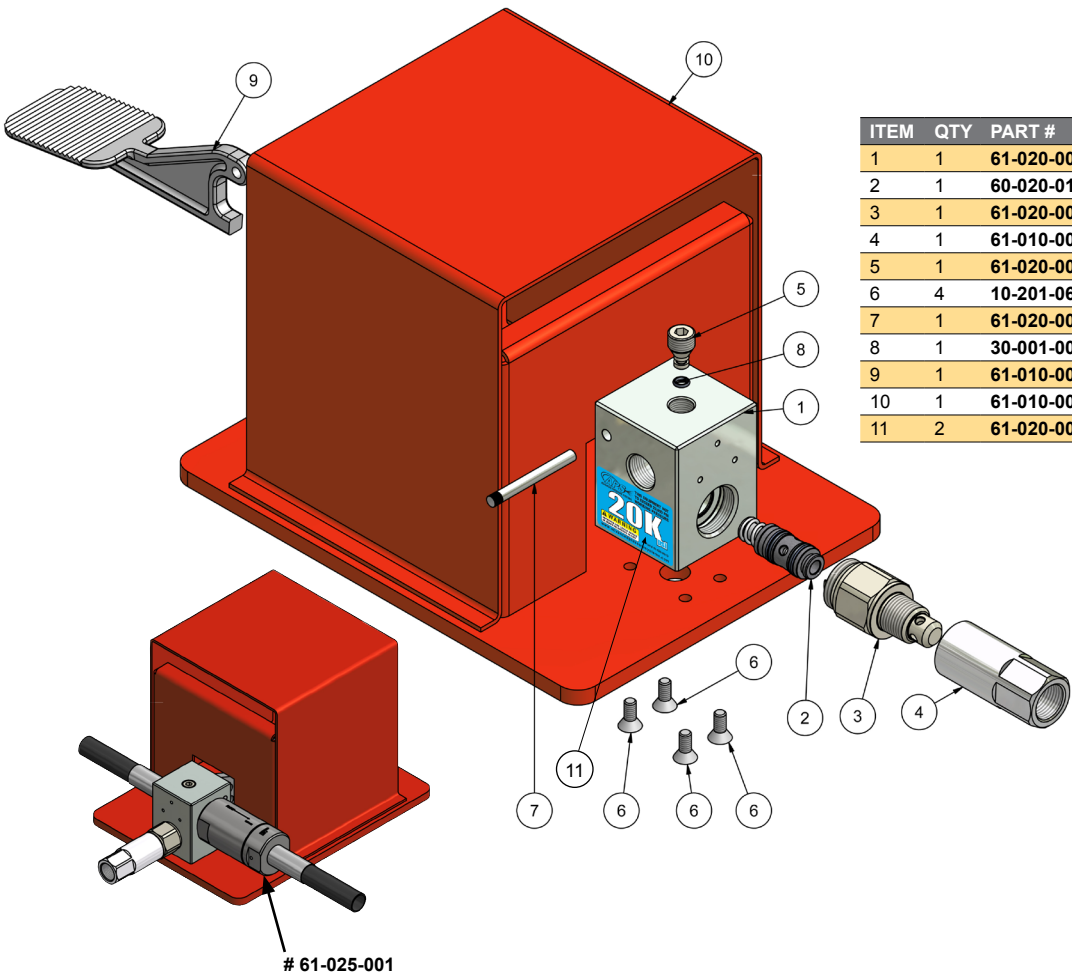

ITEM	QTY	PART #	DESCRIPTION
1	1	61-020-001	20K Foot Gun Block
2	1	60-020-010	20K Cartridge Assembly
3	1	61-020-004	Dump Adapter - 20K Foot Gun
4	1	61-010-002	Dump Tube
5	1	61-020-002	Plug for 20K Foot Gun Block
6	4	10-201-063	1/4"-20 c'sink Socket Head Screws 5/8" Long
7	1	61-020-005	Pivot Pin
8	1	30-001-009	O-Ring
9	1	61-010-007	Foot Pedal
10	1	61-010-004	Foot Gun Base Assembly
11	2	61-020-001D	20K psi Safety Decal - Gun Block

**Easy-Change Cartridge Assembly** The cartridge assembly enables rebuilding of the gun in the field in 30 seconds or less with common tools.



## 20K Air-Operated Dump Valves

The Air-Operated Dump Valve allows an operator to remotely control pressure in cleaning applications for 20,000 psi. When air is sent to the cylinder, the valve closes and allows the system to build pressure. The valve opens when the air is exhausted, reducing system pressure to near atmospheric.

- 30-second field replaceable cartridge design for minimal downtime.
- Remote pneumatic operation for reduced operator fatigue and added convenience and safety.
- Inlet and outlet connections threaded 9/16 MP.
- Heavy-duty air cylinder.
- All components precision machined from stainless steel.

Part #	Description
61-020-019	20K Air Actuated Foot Gun
60-020-010	20K Cartridge Assembly



### 20K Air Actuated Foot Gun - Part # 61-020-019

ITEM	QTY	PART #	DESCRIPTION
1	1	61-020-001	20K Foot Gun Block
2	1	61-001-002	Spacer Block
3	1	61-020-004	Dump Adapter 20K Foot Gun
4	1	61-010-002	Dump Tube
5	1	61-001-003	Plunger for Air Actuator
6	1	61-001-004	Air Actuator
7	1	61-020-005	20K Foot Gun Pivot Pin
8	4	10-001-200	1/4"-20 SHCS 2" Long
9	1	10-001-125	1/4"-20 SHCS 1-1/4" Long
11	1	61-002-001	Plate - 20K Air Actuated Foot Gun
10	1	61-020-002	Plug for 20K Foot Gun Block
12	1	30-001-009	O-Ring
13	4	10-001-112	1/4"-20 SHCS 1-1/8" Long
14	1	60-020-010	20K Cartridge Assembly
15	1	61-010-006	Foot Gun Base Plate
16	4	10-201-175	C'sink 1/4"-20 Flat Head SHCS, 1-3/4" Long SS
17	2	61-020-001D	20K psi Safety Decal - Gun Block

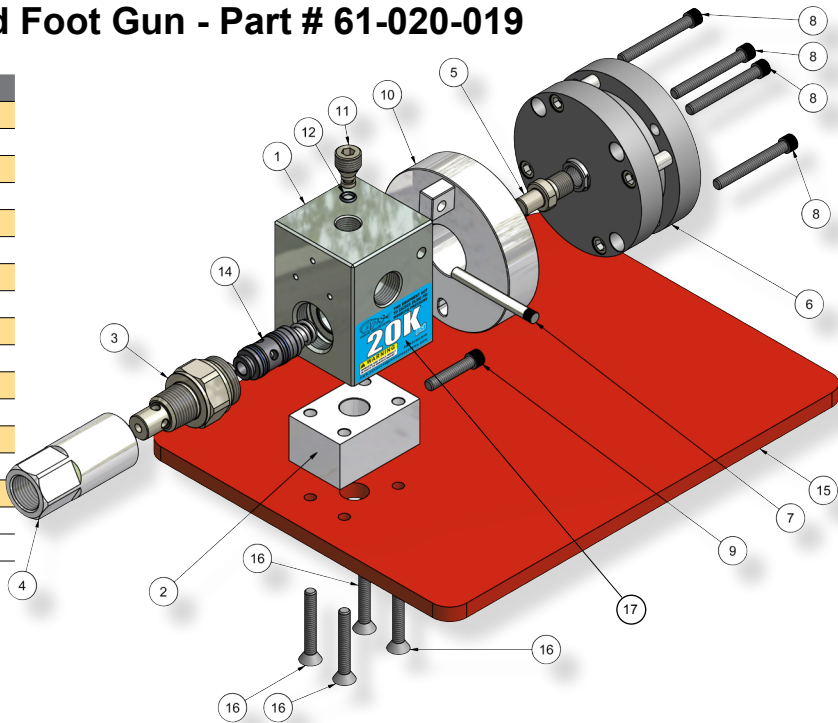

**FDV-20K Flow Divider Valve** The new Advanced Pressure Systems **Flow Divider Valve (FDV)** is for applications where two dump style guns are to be operated from one pump. The FDV will maintain full pressure to either gun when the other gun is dumping. When both guns are operating, the flow and pressure will be unaffected. These valves are easy to set up. They are made of rugged construction, and the only wear part is a cartridge that can be quickly changed in the field.

## Easy-Change Cartridge Assembly

The cartridge assembly enables rebuilding of the FDV in the field in 30 seconds or less with common tools.

**20K FDV Cartridge #70-020-011**

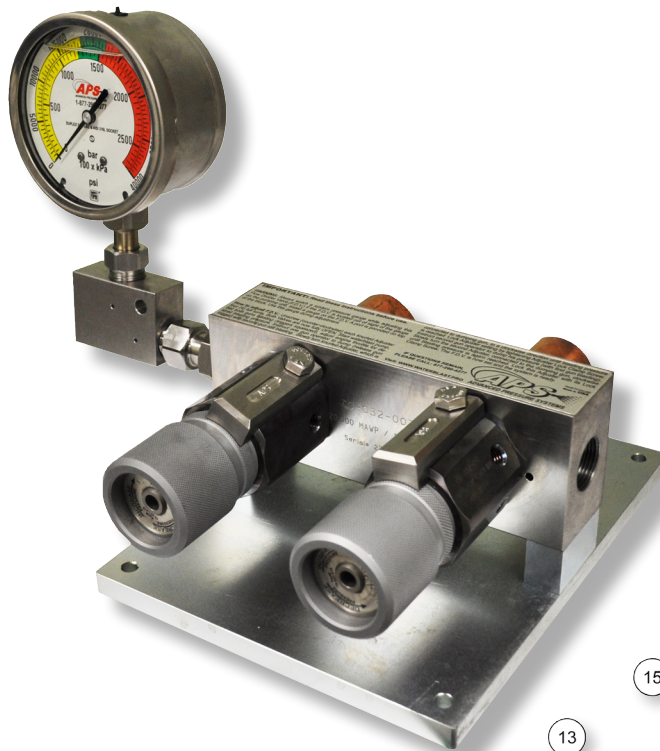

Part #	Description
70-032-001	Complete 20K Flow Divider Valve
70-032-002	Complete 20K Flow Divider Valve w/Gauge

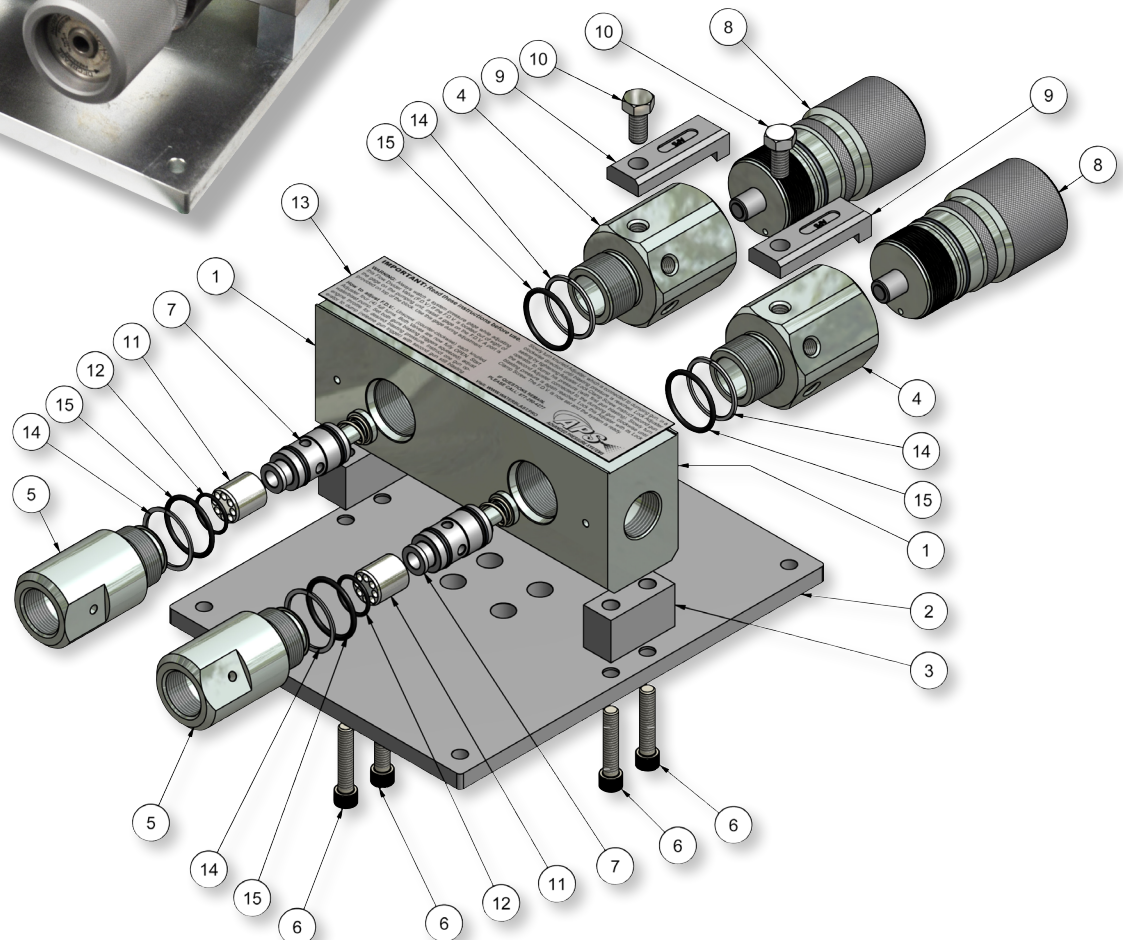

## 20K FLOW DIVIDER VALVE (FDV)

ITEM	QTY	PART #	DESCRIPTION
1	1	70-032-003	20K FDV Manifold
2	1	70-022-014	15/20K FDV Base Plate
3	2	70-022-013	15/20K FDV Base Plate Support Block
4	2	70-032-017	20K FDV Adjuster Adapter
5	2	70-032-016	20K FDV Discharge Adapter
6	4	10-002-150	SHCS 5/16"-18 x 1-1/2" long SS
7	2	70-020-011	20K FDV Cartridge Assembly
8	2	70-022-004	15/20K FDV Adjuster Handle Assembly

ITEM	QTY	PART #	DESCRIPTION
9	2	70-110-008	15/20K FDV Adjuster Locking Clamp
10	2	10-016-075	Bolt, Hex. Head 3/8"-16 x 3/4" long SS
11	2	70-010-013	15/20K FDV Diffuser
12	2	30-001-018	O-Ring 2-018
13	1	70-022-009	15/20K FDV Instruction Nameplate
14	4	70-032-018	20K FDV Back-up Ring (split)
15	4	30-001-122	O-Ring 2-122